



GREYSTONE

ACCURACY BY DESIGN

DUCT TEMPERATURE SENSOR TE200B Series

The B series single point rigid duct temperature sensor utilizes a precision sensor that is encapsulated in 6.35 mm (0.25") OD, 304 series stainless steel probe and is available in various lengths (see ordering chart) All probes provide excellent heat transfer, fast response and resistance to moisture penetration. It is available with a variety of enclosures.

SPECIFICATION:

Sensor Type:.....Thermistor or RTD
See Ordering Chart

Temperature Range:..-20 to 105 °C (-4 to 221 °F)
Higher Ranges Available
Contact Greystone

Wire Material:.....PVC insulated, parallel bonded
(Type 2, 100 ohm platinum uses FT-4)

Probe Material:.....304 Series Stainless Steel

Probe Dimensions:.....0.25" (6.35 mm) Diameter

Enclosure:.....Standard - ABS - UL94-V - NEMA 12 (IP64)
Round (E) - ABS - NEMA 12 (IP64)
Metal (M) - Gal. Steel - NEMA 1 (IP30)
Weatherproof (W) - Cast Alum. NEMA 3R (IP64)

Termination:.....Pigtail 2 or 3 wire
Terminal block with (E) enclosure

TYPICAL INSTALLATION:

For complete installation and wiring details, please refer to the product installation instructions.

The duct type probes are installed in the side of the duct to monitor a single point temperature within the duct. Select a probe length that allows the probe to span the duct width. Install the probe in a straight section of duct at a suitable distance downstream from any heating, cooling or humidification devices.

Each enclosure style provides mounting tabs on the outside of the enclosure for ease of installation.

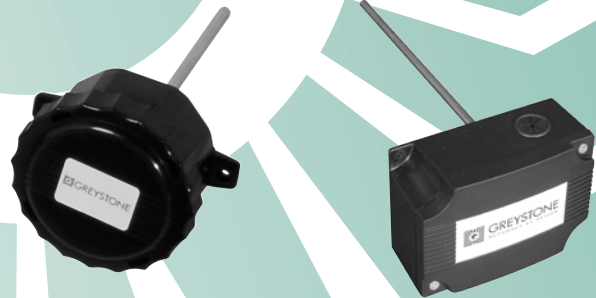
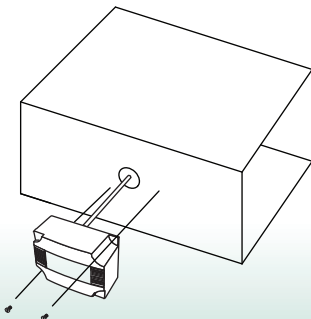

PART NUMBER SELECTED

PRODUCT SELECTION INFORMATION:

MODEL	Product Description
TE200B	Duct Temperature Sensor

CODE	Enclosure (ABS enclosure is standard)
-	ABS enclosure, standard (no code required, leave blank)
M	Metal utility box
E	Round ABS, w/gasketed cover
W	Aluminum weatherproof box

CODE	Sensor
2	PT100-100 Ω Plat. IEC 751, 385 Alpha, thin film
5	1801 Ω, NTC Thermistor, ±0.2 C
6	3000 Ω, NTC Thermistor, ±0.2 C
7	10,000 Ω, Type 3, NTC Thermistor, ±0.2 C
8	2.252 KΩ, NTC Thermistor, ±0.2 C
9	100,000 Ω, NTC Thermistor, ±0.2 C
11	LM334 IC, 1.0uA/ C
12	PT1000-1000 Ω Platinum, IEC 751, 385 Alpha, thin film
13	1000 Ω Nickel
14	10,000 Ω, Type 3, NTC Therm., ±0.2 C c/w 11K shunt resistor
15	PT3000 PTC Platinum, ±0.2 C
20	20,000 Ω, NTC Thermistor, ±0.2 C
21	LM335 IC, 10mv/ C
24	10,000 Ω, Type 2, NTC Thermistor, ±0.2 C

CODE	Probe Length
A2	50 mm (2")
B2	100 mm (4")
C2	150 mm (6")
D2	200 mm (8")
E2	300 mm (12")
F2	450 mm (18")

TE200B - 7 E 2

Dimensions:

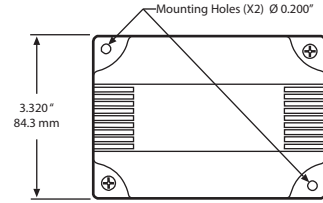
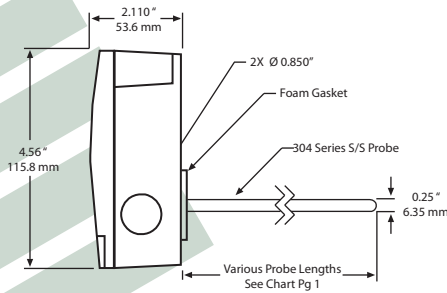
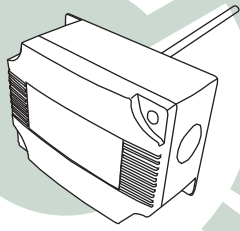

ABS Enclosure

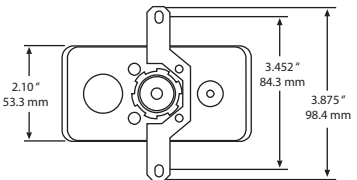
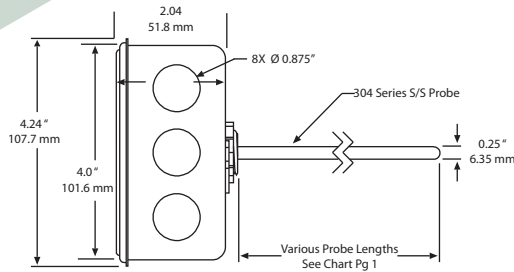
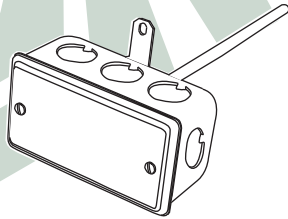

Metal Enclosure (M)

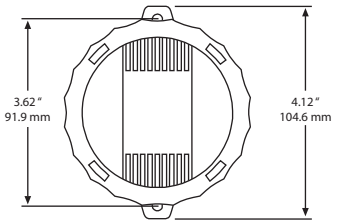
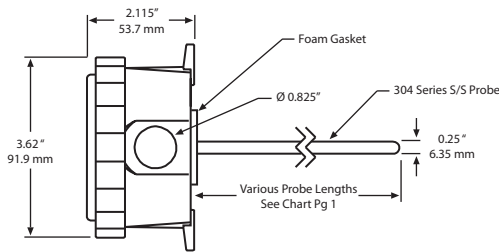
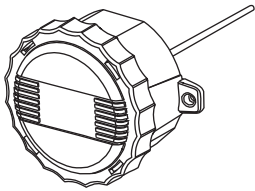

Round ABS Enclosure (E)

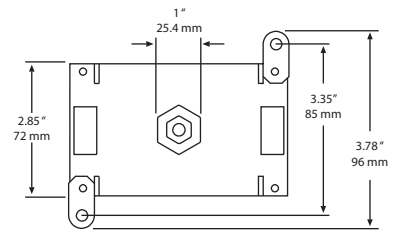
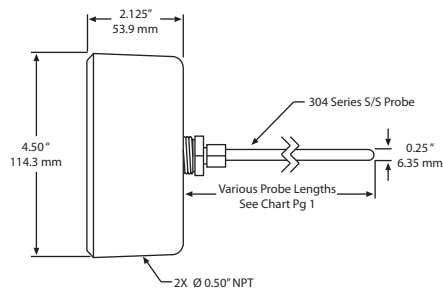
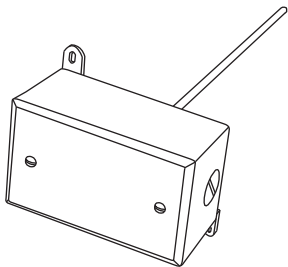

Weatherproof Enclosure (W)

Greystone Energy Systems, Inc. reserves the right to make design modifications without prior notice.



GREYSTONE

ACCURACY BY DESIGN

Greystone Energy Systems, Inc.
150 English Drive, Moncton, NB
Canada E1E 4G7

(506) 853-3057 Fax: (506) 853-6014
North America: 1-800-561-5611
e-mail: mail@greystoneenergy.com
www.greystoneenergy.com

RoHS
COMPLIANT



Greystone Energy Systems Inc. is one of North America's largest ISO registered manufacturers of HVAC sensors and transducers for Building Automation Management Systems.

We have conscientiously established a worldwide reputation as an industry leader by maintaining leading-edge design technology, prompt technical support, and a commitment to on-time deliveries. We take pride in our Quality Management System which is ISO 9001 certified, assuring our customers of consistent product reliability.

GREYSTONE HAS AN ISO 9001 REGISTERED QUALITY SYSTEM